

# REVISION HISTORY

REV	DESCRIPTION	INCORP BY	DATE	CHECKED
-----	-------------	-----------	------	---------

## NOTES:

1. REMOVE BURRS AND BREAK SHARP EDGES.

## Note:

Machine the (1.481) length of of the spacer to provide 0.002"-0.000" bearing play.

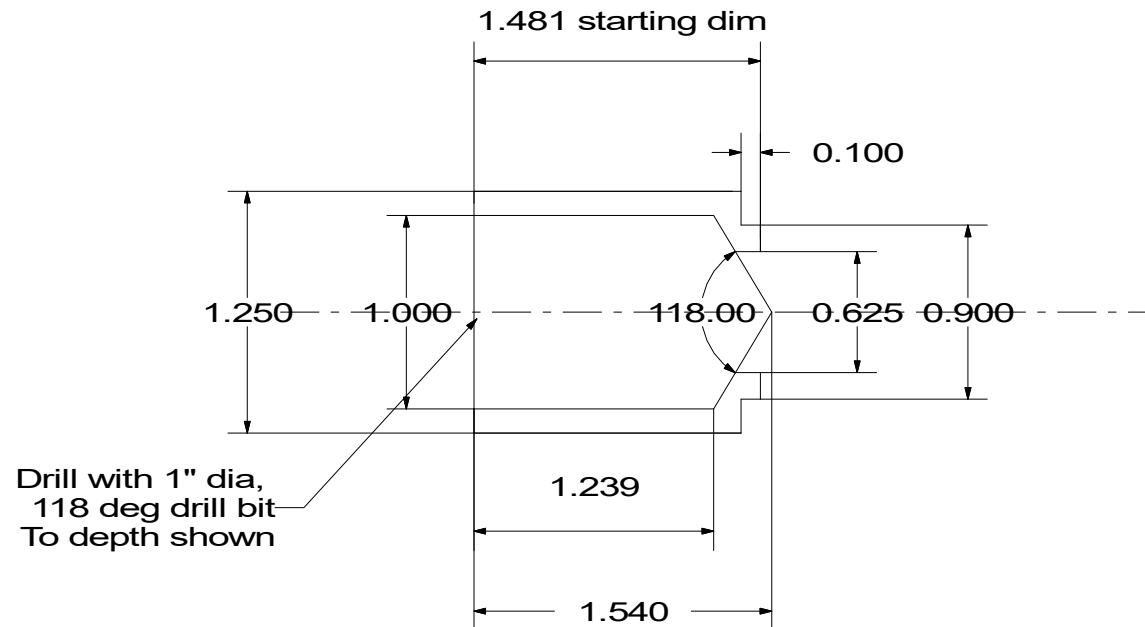

Material Specifications		CONTRACT NO.		COMPANY			
1144 carbon steel 1.25" rnd		DRAWN BY XXX		DATE X/X/XX		EtaTech, Inc.	
		CHECKED BY XXX				TITLE	
		DESIGNED BY XXX				Lotus Bearing Spacer	
NEXT ASSY		DESIGN ACTIVITY		SIZE	FSCM NO.	DWG NO. / FILE NAME	REV
USED ON		CUSTOMER		A		100-XXX-000	-
APPLICATION				SCALE	DATE	SHEET	
				1:1	X/X/09	1 of 1	

UNLESS OTHERWISE SPECIFIED  
DIM ARE IN INCHES  
TOL ON ANGLE  $\pm 0^{\circ} 30'$   
.XX  $\pm .03$  .XXX  $\pm .010$   
INTERPRET DIM AND TOL PER  
ASME Y14.5M - 1994  
DO NOT SCALE DRAWING  
THIRD ANGLE PROJECTION

