

BA

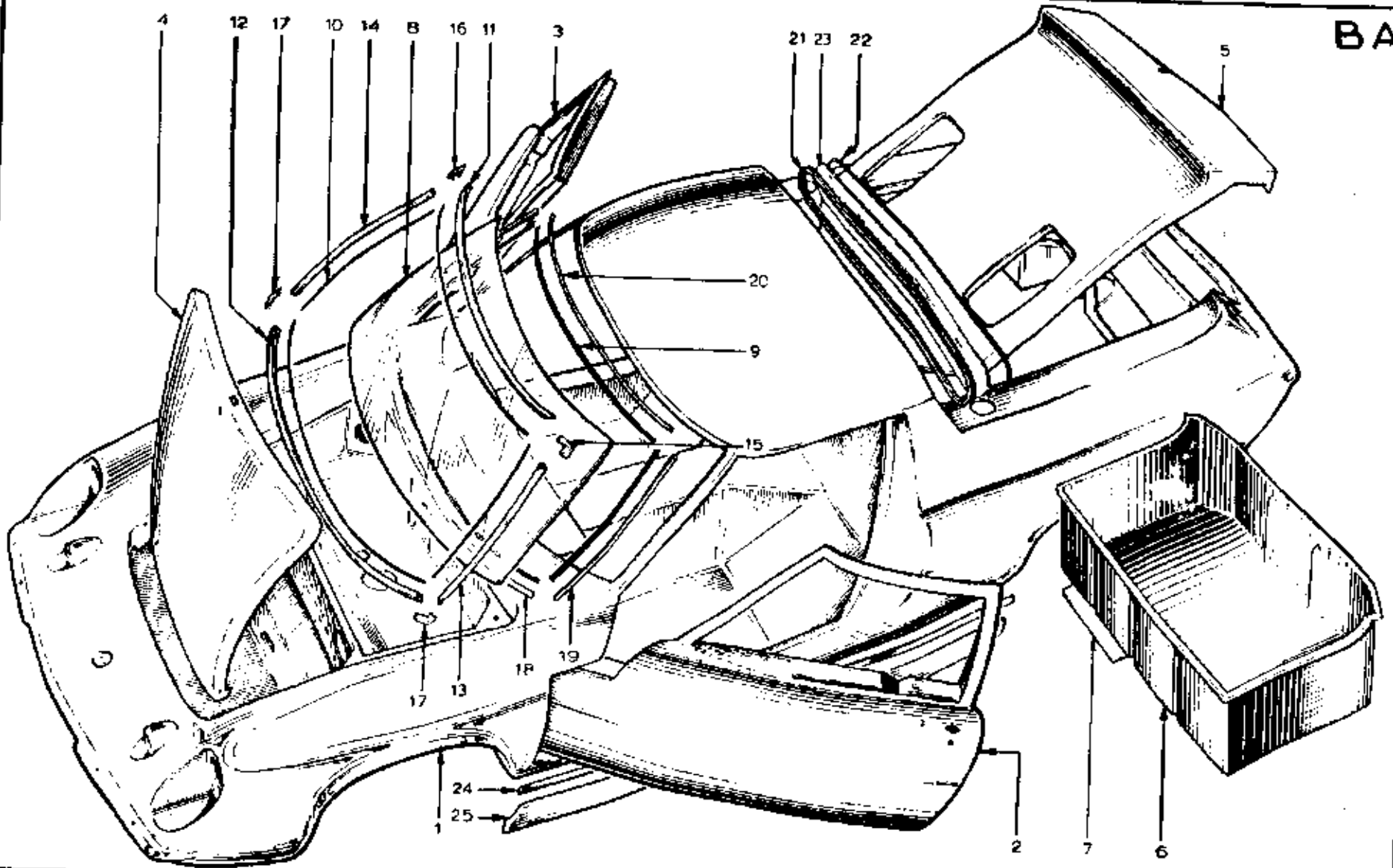

B 109

PLATE	PART NO.	QUANTITY					STEERING		DESCRIPTION	CHANGE POINT	BULLETIN REF.
		ALL	T/C	T/C Fed.	Special	Spec. Fed.	LH	RH			
Ref. No.											
BA1	A074 B 1800S		1		1			*	Shell. Body,		
	A074 B 1801S		1		1			*	Shell. Body,		
	B074 B 1801S			1					Shell. Body,		
	C074 B 1801S					1			Shell. Body,		
BA2	A065 B 0089S	1							Shell. Door, - L/H		
BA3	A065 B 0088S	1							Shell. Door, - R/H		
BA4	A046 B 0030S	1							Lid. Bonnet,		
	X054 B 1820Z	1							Strip. Bonnet Reinforcing,		
	434	6							Rivet. Strip Securing,		
	A036 B 6213V	1							Sealing. Front Stowage Compartment,		
BA5	A074 B 0040Z	1							Lid. Engine Compartment,		
BA6	X054 B 0059S	1							Box. Luggage,		
	68N	2							Bolt. Box Securing,		
	113	2							Washer.		
BA7	X046 B 2005Z	1							Shield. Heat, - Metal		
	X046 B 2007Z	1							Shield. Heat, - Asbestos		
BA8	X046 B 0029Z	1							Windscreen.		
	X054 B 0029Z	1							Windscreen. Tinted, (Optional)		
BA9	A050 B 6182Z	1							Strip. Sealing,		
BA10	A050 B 6181Z	1							Strip. Sealing,		
0972.											

PLATE Ref. No.	PART NO.	QUANTITY					STEERING		DESCRIPTION	CHANGE POINT	BULLETIN REF.
		ALL	T/C	T/C Fed.	Special	Spec. Fed.	LH	RH			
	A054 B 6132Z	2							Blocks. Mounting,		
BA11	A054 B 6118Z	1							Finish. External Top,		
BA12	A054 B 6119Z	1							Finish. External Bottom,		
BA13	A054 B 6120Z	1							Finish. External L/H,		
BA14	A054 B 6126Z	1							Finish. External R/H,		
BA15	A054 B 6133Z	1							Clip. Top L/H Corner,		
BA16	A054 B 6134Z	1							Clip. Top R/H Corner,		
BA17	A050 B 6190Z	2							Clip. Bottom Corner,		
BA18	A054 B 6122Z	1							Trim. Windscreen Internal Base,		
BA19	A054 B 6123Z	2							Trim. Windscreen Internal Side,	Up to Chassis No 1657P - 1088Q - 2468R.	
BA20	A054 B 1621Z	1							Trim. Windscreen Internal Top,		
	B050 B 6209Z	1							Trim. Windscreen Internal Top and Sides,	From Chassis No.s 1658P - 1089Q - 2469R.	
BA21	X054 B 1769Z	1							Weather Strip. Rear Screen,		
BA22	65 U 0009Z	1							Strip. Filler, Rear Screen		
BA23	X046 B 0349Z	1							Screen. Rear,		
	B046 B 0349Z	1							Screen. Tinted Rear, (Optional)		
BA24	A074 U 6004Z	2							Strip. Trim,		
	A074 U 6006Z	18							Clip. Attaching,		
BA25	A074 U 0111Z	1							Panel. Trim, - L/H		
0972.											

PLATE Ref. No.	PART NO.	QUANTITY					STEERING		DESCRIPTION	CHANGE POINT	BULLETIN REF.
		ALL	T/C	T/C Fed.	Special	Spec. Fed.	LH	RH			
	A074 U 0110Z	1							Panel.Trim, - R/H Tape. Double Sided Adhesive, Clip. Trim Panel Attaching,		
	A074 U 6007Z	AR									
	A074 U 6005Z	10									

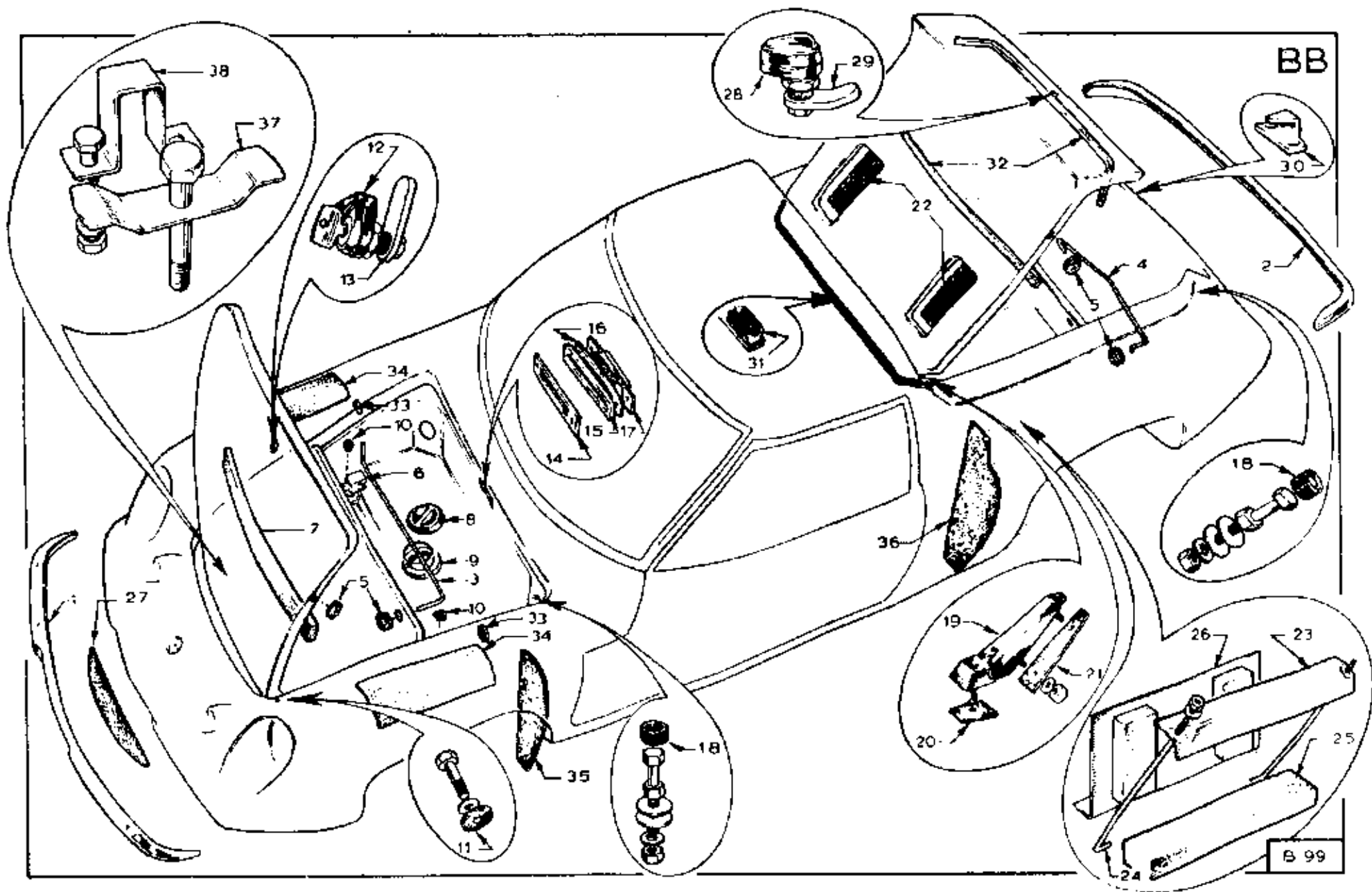

PLATE Ref: No.	PART NO.	QUANTITY					STEERING		DESCRIPTION	CHANGE POINT	BULLETIN REF
		ALL	T/C	T/C Fed.	Special	Spec. Fed.	LH	RH			
BB1	X046 B 6011Z	1							Bumper. Front,		
BB2	X046 B 6012Z	1							Bumper. Rear,		
	436B	2							Rivet. Blanking,		
	453A	8							Stud. Bumper Securing,		
	116AA	8							Washer. Fibre,		
	118	8							Washer. Plain,		
	114	8							Washer. Spring,		
	214A	8							Nut.		
BB3	X054 B 1535Z	1							Stay. Bonnet Lid,		
BB4	X046 B 1131Z	1							Stay. Engine Compartment Lid,		
BB5	X036 B 6010Z	4							Grommet. Stay Pivot,		
BB6	A054 B 1673Z	2							Clip. Stay Securing,		
BB7	X054 B 1652Z	1							Strip.foam, - Bonnet Lid		
BB8	X026 B 0371Z	1							Grommet. Handbrake Access Aperture,		
BB9	X036 K 0068Z	1							Seal. Handbrake Access Aperture,		
BB10	A054 J 6005Z	2							Grommet. Body Attaching Bolt Access,		
BB11	14B	2							Bolt. Bonnet Securing,		
	X054 B 6107Z	2							Washer. Rubber,		
	118	2							Washer. Plain,		
BB12	X046 B 6112Z	1							Lock. Bonnet,		

0972.

BB1.

PLATE	PART NO.	QUANTITY					STEERING		DESCRIPTION	CHANGE POINT	BULLETIN REF
		ALL	T/C	T/C Fed.	Special	Spec. Fed.	LH	RH			
Ref: No.											
BB13	X046 B 1362Z	1							Tab. Bonnet Lock,		
BB14	A046 B 1368Z	1							Plate. Strike, - Bonnet Lock		
BB15	A074 U 0057Z	1							Packing. - Bonnet Lock		
BB16	A074 B 2109Z	1							Seal. - Bonnet Lock		
BB17	D074 B 1368Z	1							Plate. Lacking, - Bonnet Lock		
	337	2							Screw. Securing,		
BB18	X046 B 6113Z	4							Buffer. Bonnet and Engine Compartment Lid,		
	13C	2							Bolt. Bonnet Buffer,		
	14A	2							Bolt. Engine Compartment Lid Buffer,		
	119	8							Washer. Plain,		
	116	4							Washer. Shakeproof,		
	209A	4							Nut.		
BB19	X036 B 6006Z	2							Hinge. Engine Compartment,		
BB20	A036 B 1111Z	2							Gasket. Hinge, - Front		
BB21	A036 B 1112Z	2							Gasket. Hinge, - Rear		
	113	4							Washer. Hinge to Lid,		
	206	4							Nut.		
	119	2							Washer. Hinge to Body,		
	210A	2							Nut.		
BB22	A074 U 0011Z	2							Grille. Engine Compartment Lid,		

0972.

882.

PLATE Ref: No.	PART NO.	QUANTITY					STEERING		DESCRIPTION	CHANGE POINT	BULLETIN REF.
		ALL	T/C	T/C Fed.	Special	Spec. Fed.	LH	RH			
	3168	8							Screw. Grille Securing,		
	422	8							Nut.		
BB23	A074 U 0014Z	1							Clamp. Battery,		
BB24	C074 U 0015Z	2							Rod. Battery Clamp,		
BB25	A054 B 6111V	AR							Strip. Rubber,		
BB26	A074 U 0026Z	1							Shield. Battery Heat,		
BB27	X046 B 0272Z	1							Grille. Front,		
	RST5 0808	8							Screw. Grille Securing,		
	421	8							Nut.		
	102	8							Washer.		
BB28	X046 B 6112Z	1							Lock. Engine Compartment Lid,		
BB29	X046 B 1367Z	1							Tab. Lock,		
BB30	X046 B 1366Z	1							Plate. Latch,		
	3188	2							Screw. Plate Securing,		
	102	2							Washer.		
	423	2							Nut.		
BB31	A074 V 6006V	1							Seal. Engine Compartment,		
BB32	X046 B 1289Z	2							Strip. Foam, - Engine Compartment Lid,		
BB33	X026 B 0731Z	2							Grommet. Upper Wishbone Access,		
BB34	A036 V 0083Z	2							Guard. Stone,		

0972.

BB3.

PLATE Ref. No.	PART NO.	QUANTITY					STEERING		DESCRIPTION	CHANGE POINT	BULLETIN REF.
		ALL	T/C	T/C Fed.	Special	Spec. Fed.	LH	RH			
BB35	X054 B 1271Z	2							Plate. Closing - Front Wheel Arch		
	X054 B 1272Z	2							Plate. Closing, - Rear Wheel Arch		
	434	24							Rivet. Plate Securing,		
	100	48							Washer.		
BB37	X036 B 0599Z	1							Clamp. Spare Wheel, (Steel Wheel Only)		
BB38	A074 U 0028Z	1							Bracket. Wheel Support, (Steel Wheel Only)		
	4	2							Bolt. Bracket Securing,		
	110	2							Washer.		
	208	2							Nut.		
	125	1							Washer. Spare Wheel Securing (Alloy Wheel Only)		
	30A	1							Bolt. Spare Wheel Securing (All),		

BC

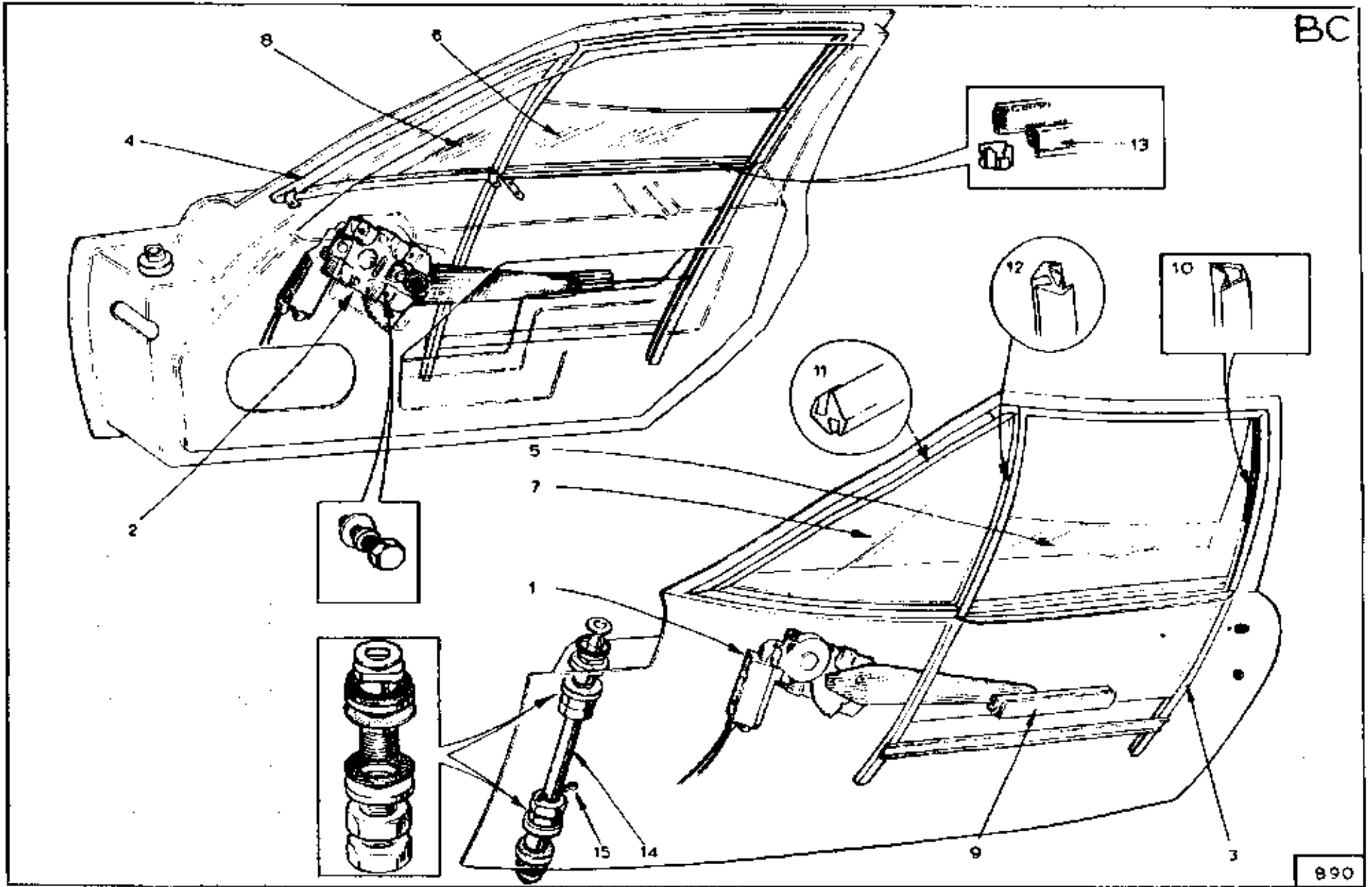

PLATE Ref. No.	PART NO.	QUANTITY					STEERING		DESCRIPTION	CHANGE POINT	BULLETIN REF.
		ALL	T/C	T/C Fed.	Special	Spec. Fed.	LH	RH			
BC1	X054 B 1495S	1							Motor. Window Operating, - L/H		
BC2	X054 B 1496S	1							Motor. Window Operating, - R/H		
	XUFB 0418	8							Bolt. Motor to Door,		
	113	8							Washer. Plain,		
	108	8							Washer. Shakeproof,		
BC3	X054 B 0791W	1							Frame. Window, - L/H		
	X054 B 0792W	1							Frame. Window, - R/H		
BC4	X054 B 0790W	1							Frame. Quarter Light, - R/H		
	X054 B 0789W	1							Frame. Quarter Light, - L/H		
	434	14							Rivet. Frame Securing,		
	305B	4							Screw.		
	100	4							Washer.		
	207	4							Nut.		
BC5	X054 B 0667Z	1							Glass. L/H Side Window,		
	X054 B 0667A	1							Glass. L/H Side Window, - Shaded (Optional)		
	A036 B 6213V	1							Seal. Window,		
BC6	X054 B 668Z	1							Glass. R/H Side Window,		
	X054 B 668A	1							Glass. R/H Side Window, - Shaded (Optional)		
	A036 B 6213V	1							Seal. Window,		
BC7	X054 B 669A	1							Glass. L/H Quarter Light,		

0972.

BC1.

PLATE	PART NO.	QUANTITY					STEERING		DESCRIPTION	CHANGE POINT	BULLETIN REF.
		ALL	T/C	T/C Fed.	Special	Spec. Fed.	LH	RH			
Ref: No.											
	B054 B 0669Z	1							Glass. L/H Quarter Light, - Shaded(Optional)		
BC8	X054 B 0670A	1							Glass. R/H Quarter Light,		
	B054 B 0670Z	1							Glass. R/H Quarter Light, - Shaded (Optional)		
BC9	X054 B 0091Z	2							Channel. Window Operating,		
	X054 B 6108Z	2							Strip. Channel Seal,		
BC10	X054 B 6023Z	2							Channel. Side Window,		
BC11	A054 B 1929Z	2							Seal. Quarter Light, - Front and Base		
BC12	A054 B 1928Z	2							Seal. Quarter Light, - Dividing Channel		
BC13	X036 B 6061Z	4							Seal. Side Window,		
	417	16							Clip.		
BC14	X046 B 0073Z	2							Pintle. Door Hinge,		
	A054 B 2000Z	4							Bush.		
	X046 B 6024Z	4							'O' Ring.		
	220A	8							Nut.		
	128D	8							Washer.		
	128CA	AR							Washer.		
	W015	12							Washer. Abrasive,		
BC15	412C	2							Pin. Split,		

BD

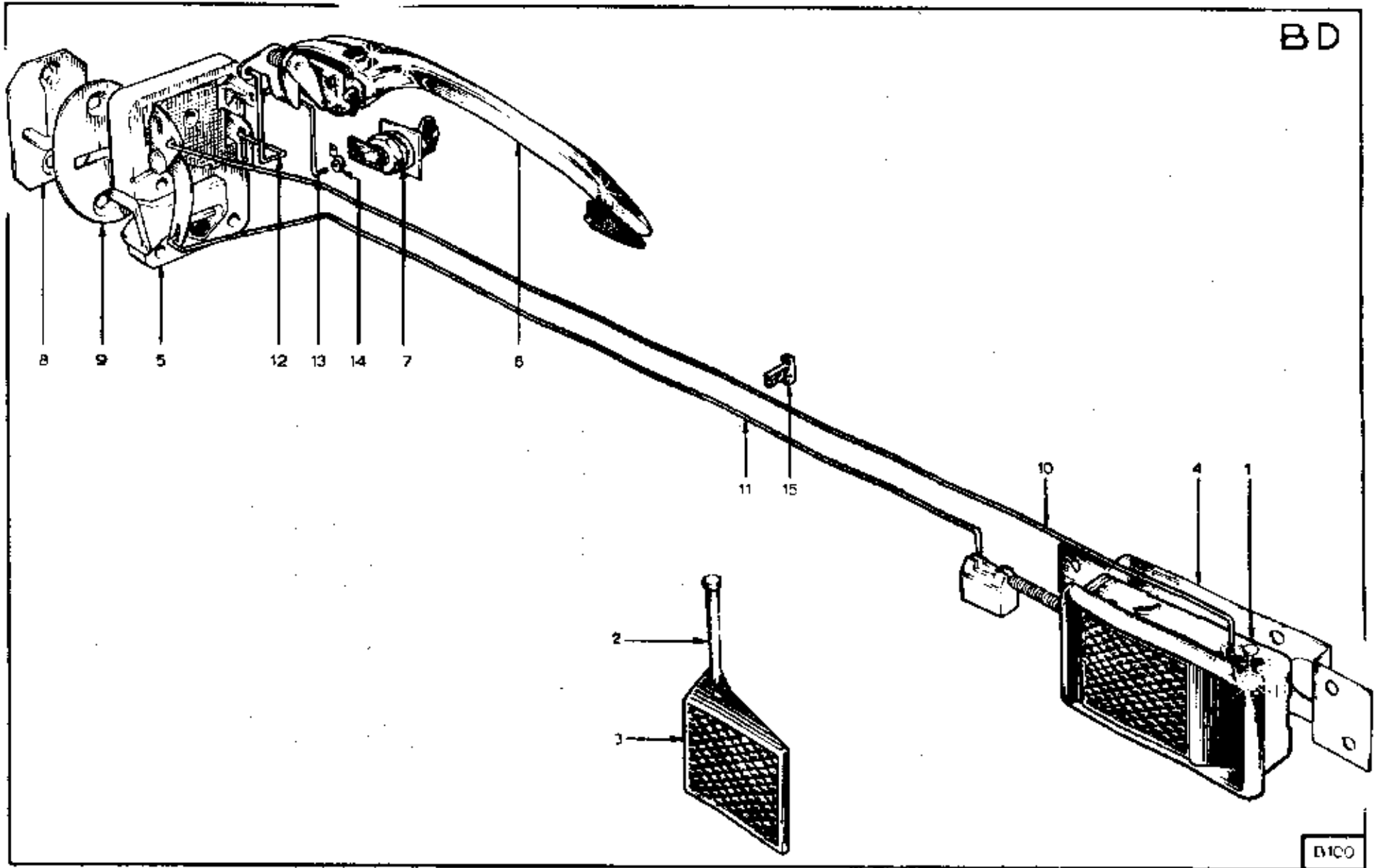

EVICO

PLATE Ref. No.	PART NO.	QUANTITY					STEERING		DESCRIPTION	CHANGE POINT	BULLETIN REF
		ALL	T/C	T/C Fed.	Special	Spec. Fed.	LH	RH			
BD1	X036 B 6151W	1							Control. Remote, - L/H		
	X036 B 6152W	1							Control. Remote, - R/H		
BD2	A036 B 6257Z	2							Pin.		
BD3	A036 B 6256Z	2							Flap.		
BD4	X046 B 1629Z	1							Bracket. Remote Control Mounting, - L/H		
	X046 B 1630Z	1							Bracket. Remote Control Mounting, - R/H		
	339	8							Fastener. Bracket to Door,		
	RSTS 1008	6							Screw. Remote Control to Bracket,		
	208	6							Nut.		
BD5	X036 B 6048W	1							Assembly. Door Lock Mechanism,		
	X036 B 6049W	1							Assembly. Door Lock Mechanism,		
	335A	8							Screw. Lock Mechanism to Door,		
	208	8							Nut.		
BD6	X036 B 6052W	1							Handle. External, - L/H Door		
	X036 B 6053W	1							Handle. External, - R/H Door		
	X036 B 6168Z	2							Gasket. Door Handle Small,		
	X036 B 6164Z	2							Gasket. Door Handle Large,		
	38	4							Screw. Handle to Door,		
	101	4							Washer.		
BD7	A036 B 6191W	2							Lock. Private,		

PLATE Ref. No.	PART NO.	QUANTITY					STEERING		DESCRIPTION	CHANGE POINT	BULLETIN RE
		ALL	T/C	T/C Fed.	Special	Spec. Fed.	LH	RH			
	LUFN 120F	2							Nut. Securing,		
	A036 B 1921Z	2							Plate. Retaining,		
	X036 B 6096Z	2							Gasket.		
BD8	X036 B 6054Z	2							Plate. Striker,		
BD9	X036 B 6055Z	2							Plate. Cover,		
	335A	4							Screw. Striker Securing,		
BD10	X054 B 1411Z	1							Rod. Locking, - L/H		
	X054 B 1412Z	1							Rod. Locking, - R/H		
BD11	X054 B 1413Z	1							Rod. Opening, - L/H		
	X054 B 1414Z	1							Rod. Opening, - R/H		
BD12	X054 B 1415Z	1							Rod. Door Handle, - L/H		
	X054 B 1416Z	1							Rod. Door Handle, - R/H		
BD13	X054 B 1423Z	1							Rod. Key Locking, - L/H		
	X054 B 1424Z	1							Rod. Key Locking, - R/H		
BD14	A036 U 6001Z	12							Assembly. Clip and Bush,		
BD15	X036 B 6155Z	4							Clip. Anti-rattle,		

BE

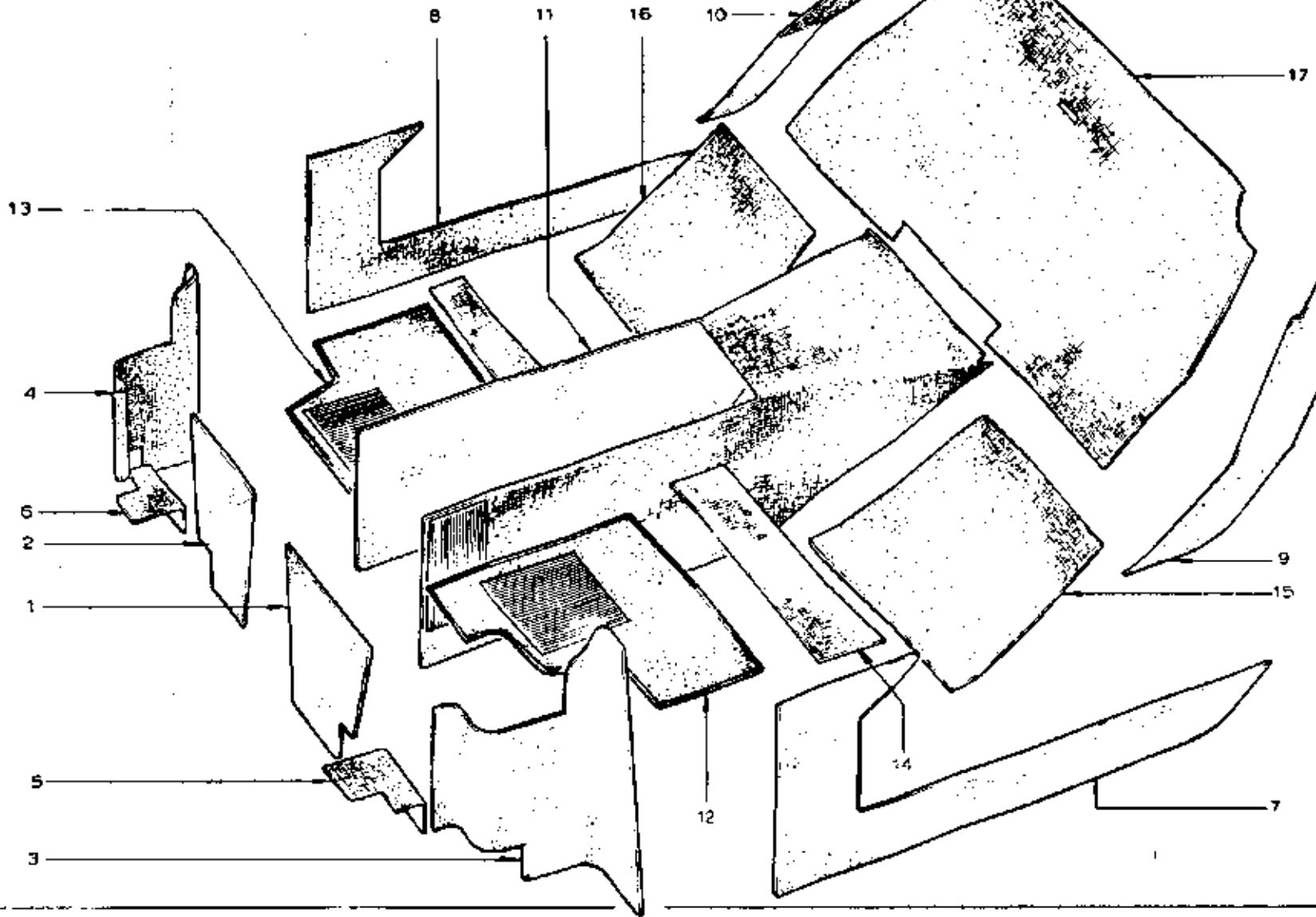

B 101

PLATE	PART NO.	QUANTITY					STEERING		DESCRIPTION	CHANGE POINT	BULLETIN REF	
		ALL	T/C	T/C Fed.	Special	Spec. Fed.	LH	RH				
Ref: No.												
									NOTE: REFER TO PAGE 9 FOR ORDERING INSTRUCTIONS.			
BE1	A074 V 0049S	1							Carpet. Footbox Large, - L/H			
BE2	A074 V 0050S	1							Carpet. Footbox Large, - R/H			
BE3	A074 V 0047S	1							Carpet. Wheelarch, - L/H			
BE4	A074 V 0046S	1							Carpet. Wheelarch, - R/H			
BE5	A074 V 0045S	1							Carpet. Footbox Small, - L/H			
BE6	A074 V 0044S	1							Carpet. Footbox Small, - R/H			
BE7	A074 V 0043S	1							Carpet. Door Surround, - L/H			
BE8	A074 V 0042S	1							Carpet. Door Surround, - R/H			
BE9	A074 V 0079S	1							Carpet. Doorpost, - L/H			
BE10	A074 V 0078S	1							Carpet. Doorpost, - R/H			
BE11	A074 V 0701S		1	1	1	1		*	Assembly. Tunnel Top Carpet,			
	A074 V 0702S		1		1			*	Assembly. Tunnel Top Carpet,			
BE12	A074 V 0051S	1							Carpet. Footmat, - L/H			
BE13	A074 V 0052S	1							Carpet. Footmat, - R/H			
BE14	A065 B 2052S	1							Carpet. Rear Floor,			
BE15	A074 V 0053S	1							Carpet. Lower Bulkhead, - L/H			
BE16	A074 V 0054S	1							Carpet. Lower Bulkhead, - R/H			
BE17	A074 V 0075Z			1		1			Trimboard.			
	A074 V 0017Z		1		1			*	*	Trimboard.		

0972.

BE1.

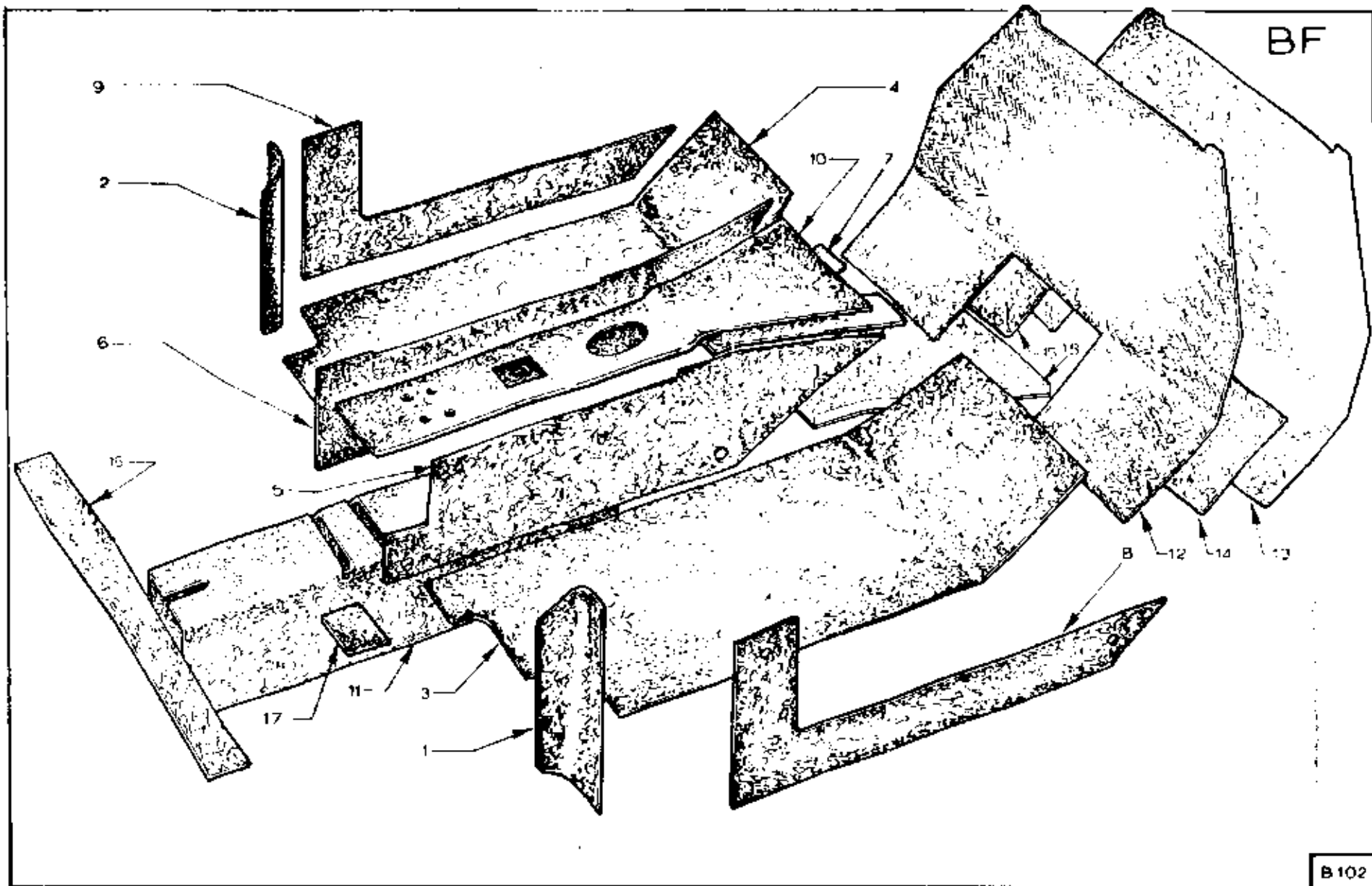

PLATE Ref: No.	PART NO.	QUANTITY					STEERING		DESCRIPTION	CHANGE POINT	BULLETIN RE
		ALL	T/C	T/C Fed.	Special	Spec. Fed.	LH	RH			
BF1	A074 V 0011Z		1	1	1		*	*	Felt. Front Wheelarch, - L/H		
	B074 V 0011Z					1			Felt. Front Wheelarch, - L/H		
BF2	A074 V 0012Z		1	1	1		*	*	Felt. Front Wheelarch, - R/H		
	B074 V 0012Z					1			Felt. Front Wheelarch, - R/H		
BF3	B074 V 0001Z		1	1	1		*	*	Felt. Floor, - L/H		
	C074 V 0001Z					1			Felt. Floor, - L/H		
BF4	B074 V 0002Z		1	1	1		*	*	Felt. Floor, - R/H		
	C074 V 0002Z					1			Felt. Floor, - R/H		
BF5	C074 V 0015Z	1							Felt. Tunnel Side, - L/H		
BF6	C074 V 0016Z	1							Felt. Tunnel Side, - R/H		
BF7	A074 V 0033Z	1							Felt. Tunnel Top Rear,		
BF8	B074 V 0013Z		1	1	1		*	*	Felt. Door Surround, - L/H		
	C074 V 0013Z					1			Felt. Door Surround, - L/H		
BF9	B074 V 0014Z		1	1	1		*	*	Felt. Door Surround, - R/H		
	C074 V 0014Z					1			Felt. Door Surround, - R/H		
BF10	A074 V 0711Z		1	1	1		*	*	Felt. Tunnel Top,		
	B074 V 0711Z					1			Felt. Tunnel Top,		
BF11	A074 V 0710Z	1							Felt. Tunnel Saddle,		
BF12	B074 B 2093Z	1							Felt. Bulkhead,		
BF13	A074 V 0019Z		1	1	1		*	*	Felt. Bulkhead,		

0972.

BF1.

PLATE	PART NO.	QUANTITY					STEERING		DESCRIPTION	CHANGE POINT	BULLETIN REF
		ALL	T/C	T/C Fed.	Special	Spec. Fed.	LH	RH			
	B074 V 0019Z					1			Felt. Bulkhead,		
BF14	A074 V 0021Z		1	1	1		*	*	Felt. Lower Bulkhead, - L/H		
	B074 V 0021Z					1			Felt. Lower Bulkhead, - L/H		
BF15	A074 V 0020Z		1	1	1		*	*	Felt. Lower Bulkhead, - R/H		
	B074 V 0020Z					1			Felt. Lower Bulkhead, - R/H		
BF16	X046 B 1140Z	1							Felt. Chassis Top Box,		
BF17	A074 V 0032Z	1							Felt. Footbox,		
BF18	A074 V 0010A	1							Felt. Insulator,		
	A074 V 0010B	1							Felt. Insulator,		

BG

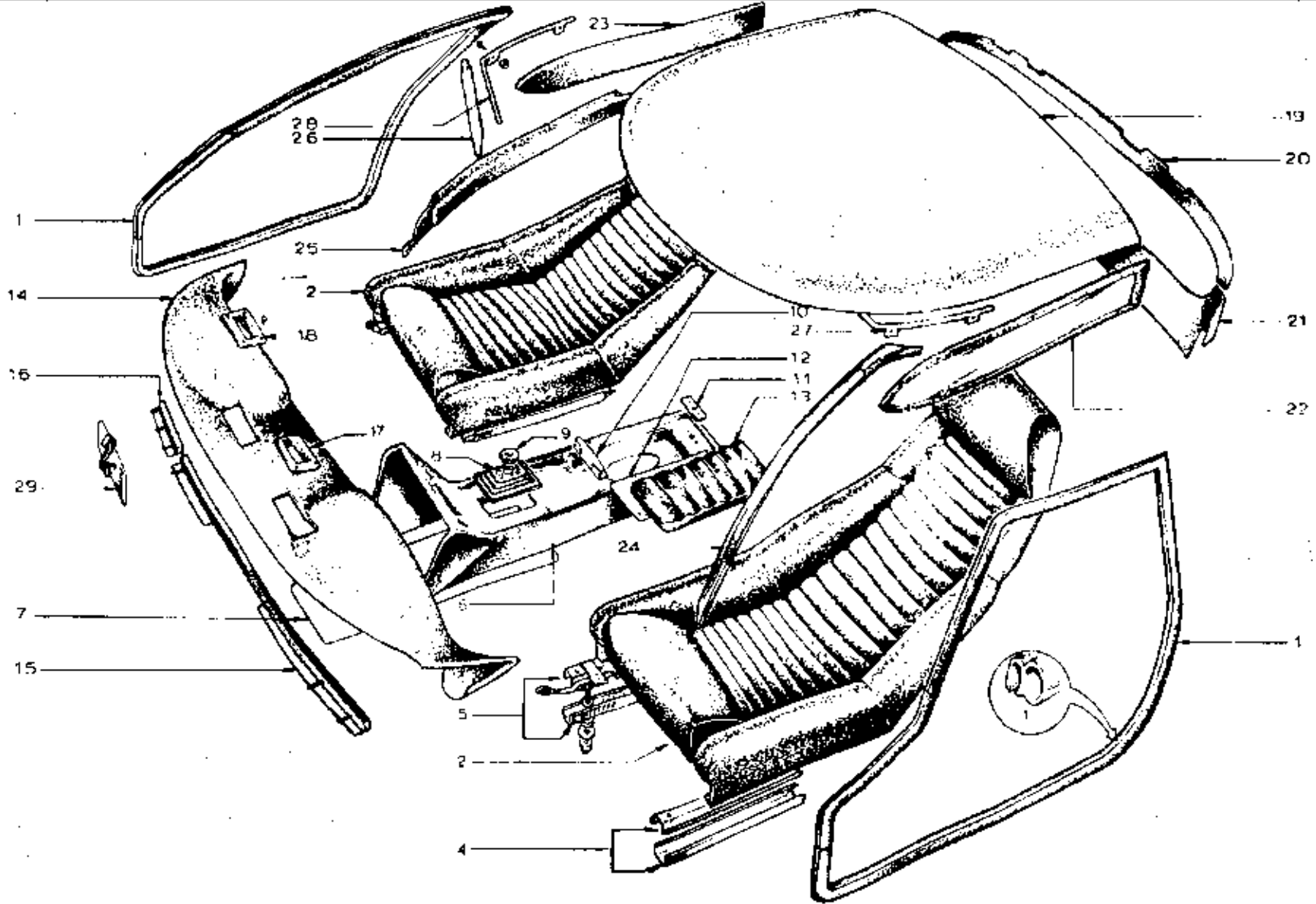

B103

PLATE Ref: No.	PART NO.	QUANTITY					STEERING		DESCRIPTION	CHANGE POINT	BULLETIN RE
		ALL	T/C	T/C Fed.	Special	Spec. Fed.	LH	RH			
BG1	A074 V 0067Z	2							Seal. Door,		
BG2	A074 V 0706S			1					Assembly. Seat, (Black) - R/H		
	B074 V 0706S					1			Assembly. Seat, - R/H		
	C074 V 0706S			1					Assembly. Seat, (Beige) - R/H		
	D074 V 0706S					1			Assembly. Seat, - L/H		
	A074 V 0707S		2	1	2		*	*	Assembly. Seat, (Black)		
	B074 V 0707S		2	1	2		*	*	Assembly. Seat, (Beige)		
	C074 B 1174S		2				*	*	Assembly. Narrow Seat, (Black)		
	D074 B 1174S		2				*	*	Assembly. Narrow Seat, (Beige)		
BG4	X054 B 6018Z	2							Runner. Seat,		
BG5	X054 B 6019Z	2							Runner. Seat, - c/w Catch		
	XUFB 0510	8							Bolt.)		
	118	16							Washer.)		
	211	16							Nut.)	Seat Fixings	
	119	16							Washer.)		
	XUFB 0516	8							Bolt.)		
	118A	8							Washer.)		
BG6	D074 V 0009Z		1				*	*	Tunnel Top.		
	A074 V 0076Z			1					Tunnel Top.		

PLATE	PART NO.	QUANTITY					STEERING		DESCRIPTION	CHANGE POINT	BULLETIN REF
		ALL	T/C	T/C Fed.	Special	Spec. Fed.	LH	RH			
Ref: No.											
	A074 V 0087Z				1		*	*	Tunnel Top.		
	A074 V 008BZ					1			Tunnel Top.		
BG7	A074 V 0712Z		1	1	1		*	*	Insulator, Body/Tunnel Top,		
	B074 V 0712Z					1			Insulator, Body/Tunnel Top,		
BG8	X050 F 6000Z	1							Grommet, Gear Lever,		
BG9	X036 J 6026Z	1							Grommet.		
BG10	X054 B 1389Z		1	1	1		*	*	Bracket, Cable Anchor,		
	X074 B 1389Z					1			Bracket, Cable Anchor,		
BG11	A074 V 0055Z	1							Plate, Armrest Fixing,		
BG12	B054 B 1461Z	1							Seal, Chassis Access,		
BG13	X054 B 0811Z	1							Armrest.		
	454E	2							Clip, Armrest Securing,		
BG14	X050 B 0230Z	1							Pad, Crash,		
BG15	X054 B 1161S		1		1			*	Trim, Facia L/H,		
	X054 B 1162S		1	1	1	1	*		Trim, Facia R/H,		
BG16	X054 B 1163S		1	1	1	1	*		Trim, Facia L/H,		
	X054 B 1164S		1		1			*	Trim, Facia R/H,		
BG17	X054 P 0069Z	1							Bezel, Demist Nozzle, - L/H		
BG18	A054 P 0070Z	1							Bezel, Demist Nozzle, - R/H		
	308	8							Screw, Bezel Attaching,		
BG19	X054 B 0360S		1	1	1		*	*	Headliner.		

0972.

BG2.

PLATE Ref. No.	PART NO.	QUANTITY					STEERING		DESCRIPTION	CHANGE POINT	BULLETIN RE
		ALL	T/C	T/C Fed.	Special	Spec. Fed.	LH	RH			
	B054 B 6127Z					1			Headliner.		
BG 20	X054 B 1443Z	1							Surround. Rear Screen, - Upper		
BG 21	X054 B 1484Z	1							Surround. Rear Screen, - Lower		
BG 22	X054 B 0717S	1							Cantrail. L/H,		
BG 23	X054 B 0718S	1							Cantrail. R/H,		
BG 24	A054 B 0361S	1							Trim. Windscreen Pillar, - L/H		
BG 25	A054 B 0362S	1							Trim. Windscreen Pillar, - R/H		
BG 26	X054 B 1720Z		2	2	2			*	Visor. Sun,		
	A074 V 6010Z					2			Visor. Sun,		
BG 27	X054 B 1291Z	1							Bracket. L/H Sun Visor Mounting,		
BG 28	X054 B 1292Z	1							Bracket. R/H Sun Visor Mounting,		
	323A	4							Screw. Bracket to Body,		
	YUFN 100F	4							Nut,		
BG 29	X036 B 6031Z	1							Mirror. Interior,		

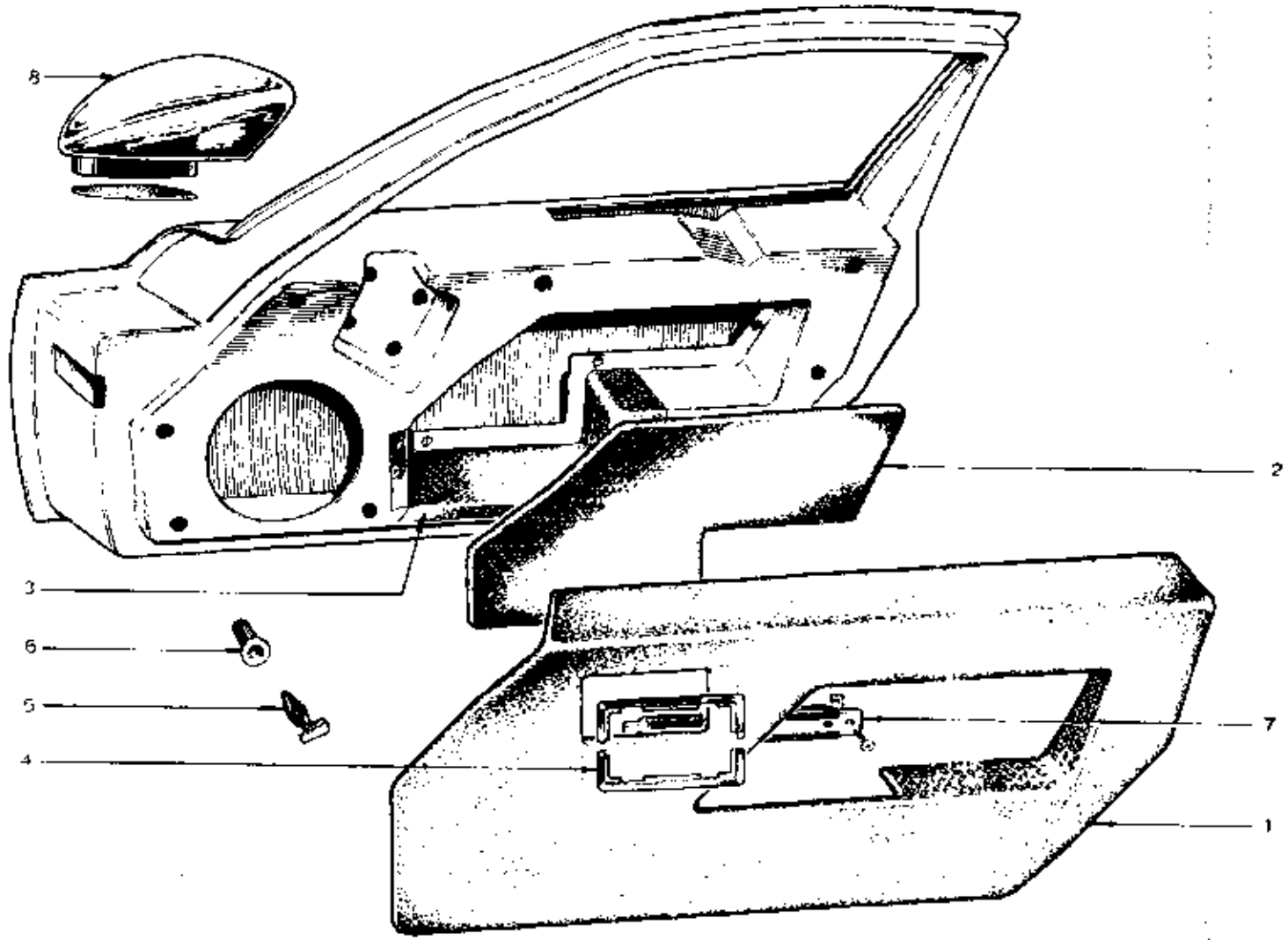
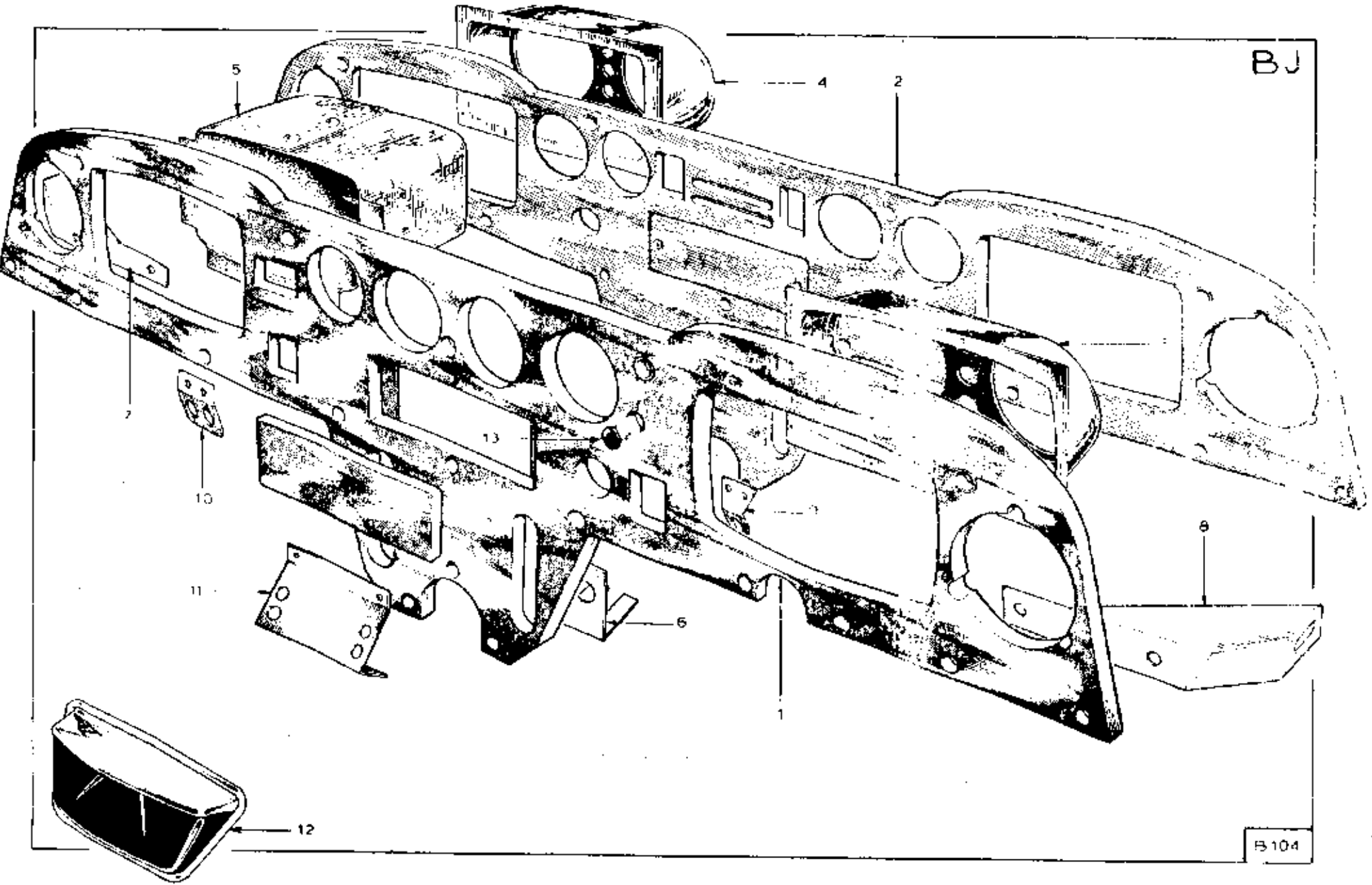

PLATE	PART NO.	QUANTITY					STEERING		DESCRIPTION	CHANGE POINT	BULLETIN REF
		AL	T/C	T/C Fed.	Special	Spec. Fed.	LH	RH			
Ref: No.											
BH1	X054 B 0721S		1	1	1		*	*	Panel . Trim, (Black) - L/H		
	A074 B 0721S		1	1	1		*	*	Panel . Trim, (Beige) - L/H		
	B074 B 0721S					1			Panel . Trim, - L/H		
	X054 B 0722S		1	1	1		*	*	Panel . Trim, (Black) - R/H		
	A074 B 0722S			1	1		*	*	Panel . Trim, (Beige) - R/H		
	B074 B 0722S					1			Panel . Trim, - R/H		
BH2	X054 B 0887S		1	1	1		*	*	Panel . Aperture (Black) - L/H		
	A074 B 0887S		1	1	1		*	*	Panel . Aperture, (Beige) - L/H		
	B074 B 0887S					1			Panel . Aperture, - L/H		
	X054 B 0888S		1	1	1		*	*	Panel . Aperture, (Black) - R/H		
	A074 B 0888S		1	1	1		*	*	Panel . Aperture, (Beige) - R/H		
	B074 B 0888S					1			Panel . Aperture, - R/H		
BH3	X054 B 1698Z	2							Cirrus . Door Pocket,		
BH4	X054 B 6059Z	4							Bezel . Door Handle,		
BH5	W0010	16							Clip . Trim Panel Mounting,		
BH6	428A	16							Snap Sac . Trim Panel Mounting,		
BH7	A074 V 0056Z	2							Plate . Door Pull Fixing,		
	313	4							Screw . Plate Securing,		
	422	4							Nut.		
BH8	X050 B 6140Z			1	2	2	*	*	Mirror . Wing,		

BJ



B104

PLATE Ref: No.	PART NO.	QUANTITY					STEERING		DESCRIPTION	CHANGE POINT	BULLETIN REF
		ALL	T/C	T/C Fed.	Special	Spec. Fed.	LH	RH			
BJ1	A074 B 0238Z		1		1			*	Panel. Facia,		
	B054 B 0237Z		1	1	1			*	Panel. Facia,		
BJ2	B 074 U 0105Z					1			Panel. Facia,		
BJ3	B054 B 1408Z		1	1	1			*	Binnacle. Instrument,		
BJ4	A074 V 0713Z					1			Binnacle. Instrument,		
BJ5	X054 B 0195Z	1							Box. Glove,		
	303C	17							Screw. Binnacle and Glove Box Securing,		
BJ6	A074 U 0008Z	2							Bracket. Facia Mounting,		
BJ7	B054 B 1459Z	1							Bracket. Facia End Support,		
BJ8	B054 B 1460Z	1							Bracket. Facia End Support,		
	335D	4							Screw. Facia Mounting,		
	3	2							Screw.		
	110	2							Washer. Plain,		
	110 A	2							Washer. Fibre,		
	208	2							Nut.		
BJ9	X054 B 1463Z		1		1	1		*	Bracket. Speedo Trip Cable,		
BJ10	X054 B 1539Z		1	1	1			*	Bracket. Speedo Trip Cable and Test Switch,		
BJ11	X054 B 0560Z	1							Bracket. Ashtray Mounting,		
BJ12	X054 B 6014W	1							Ashtray.		
BJ13	X036 B 6114Z	AR							Clip. Facia Blanking,		

1272 (AL 1)

BJ1.

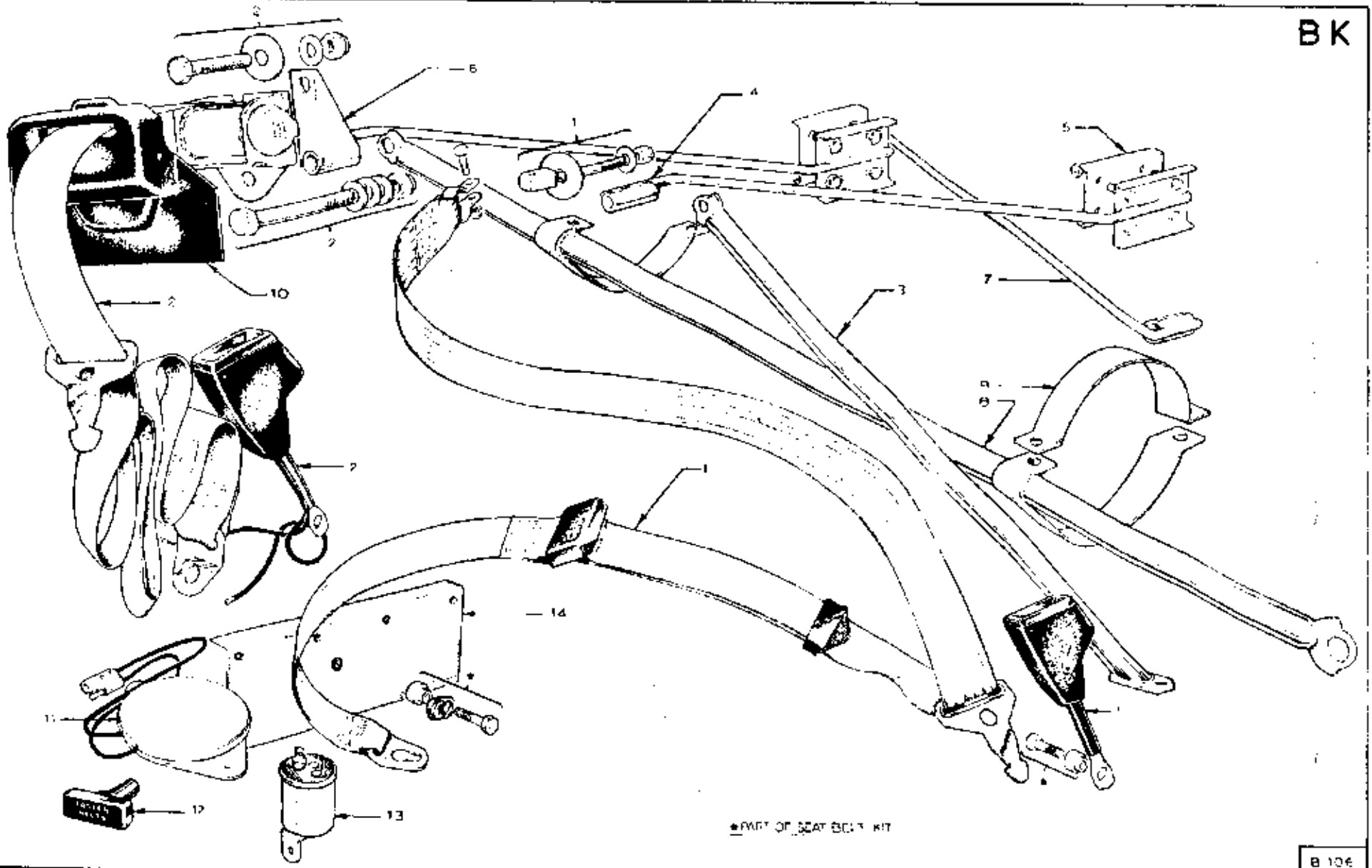

*PART OF SEAT BELT KIT

PLATE Ref: No.	PART NO.	QUANTITY					STEERING		DESCRIPTION	CHANGE POINT	BULLETIN
		ALL	T/C	T/C Fed.	Special	Spec. Fed.	LH	RH			
BK1	A074 V 6000Z		2		2		*	*	Kit. Seat Belt,		
BK2	A074 V 6008Z			2		2			Kit. Seat Belt,		
BK3	A074 U 0016Z		2		2		*	*	Rod. Tie,		
	A074 U 0033Z			1		1			Strut. Mounting, - L/H		
	A074 U 0034Z			1		1			Strut. Mounting, - R/H		
BK4	A074 U 0012Z		1		1		*	*	Strut. - R/H		
	A074 U 0013Z		1		1		*	*	Strut. - L/H		
BK5	A065 B 2039Z		2		2		*	*	Plate. Backing,		
BK6	B074 U 0035Z			1		1			Tie. Mounting, - L/H		
	B074 U 0036Z			1		1			Tie. Mounting, - R/H		
BK7	A074 U 0031Z			1		1			Tie. Mounting, - L/H		
	A074 U 0032Z			1		1			Tie. Mounting, - R/H		
BK8	A074 L 0718Z			1		1			Assembly. Catch Tank Support,		
BK9	A074 L 0094Z			2		2			Strap. Catch Tank Retaining,		
BK10	C074 V 0071Z			2		2			Cover. Seat Reel,		
BK11	A074 M 6015Z			1		1			Sensor. Seat Belt Warning,		
BK12	A074 M 6013Z			1		1			Light. Seat Belt Warning,		
BK13	A036 M 6423Z			1		1			Buzzer. Seat Belt Warning,		
BK14	C074 B 2099Z	1							Bracket. Lower Seat Belt Mounting, - L/H		
	C074 B 2100Z	1							Bracket. Lower Seat Belt Mounting, - R/H		

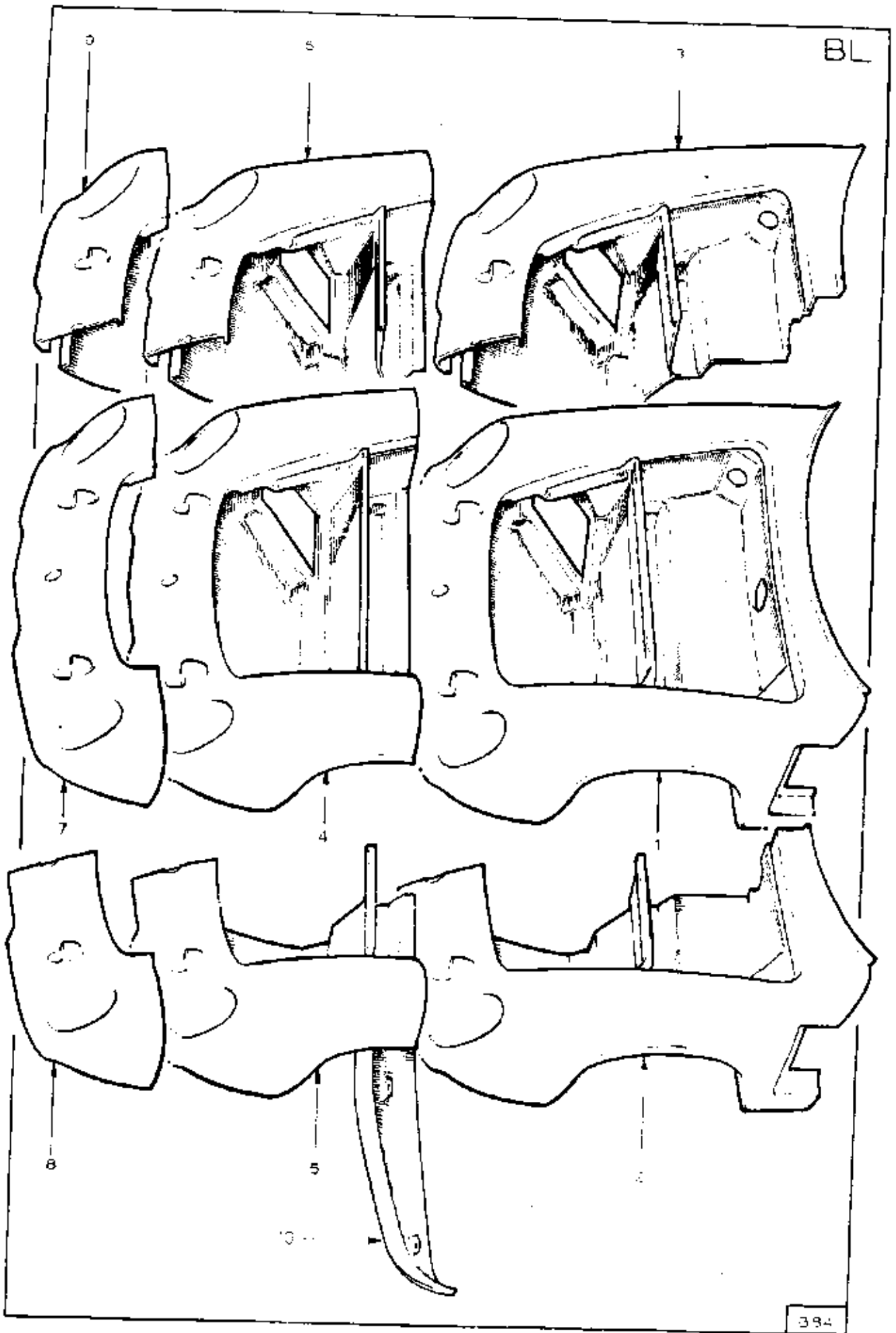
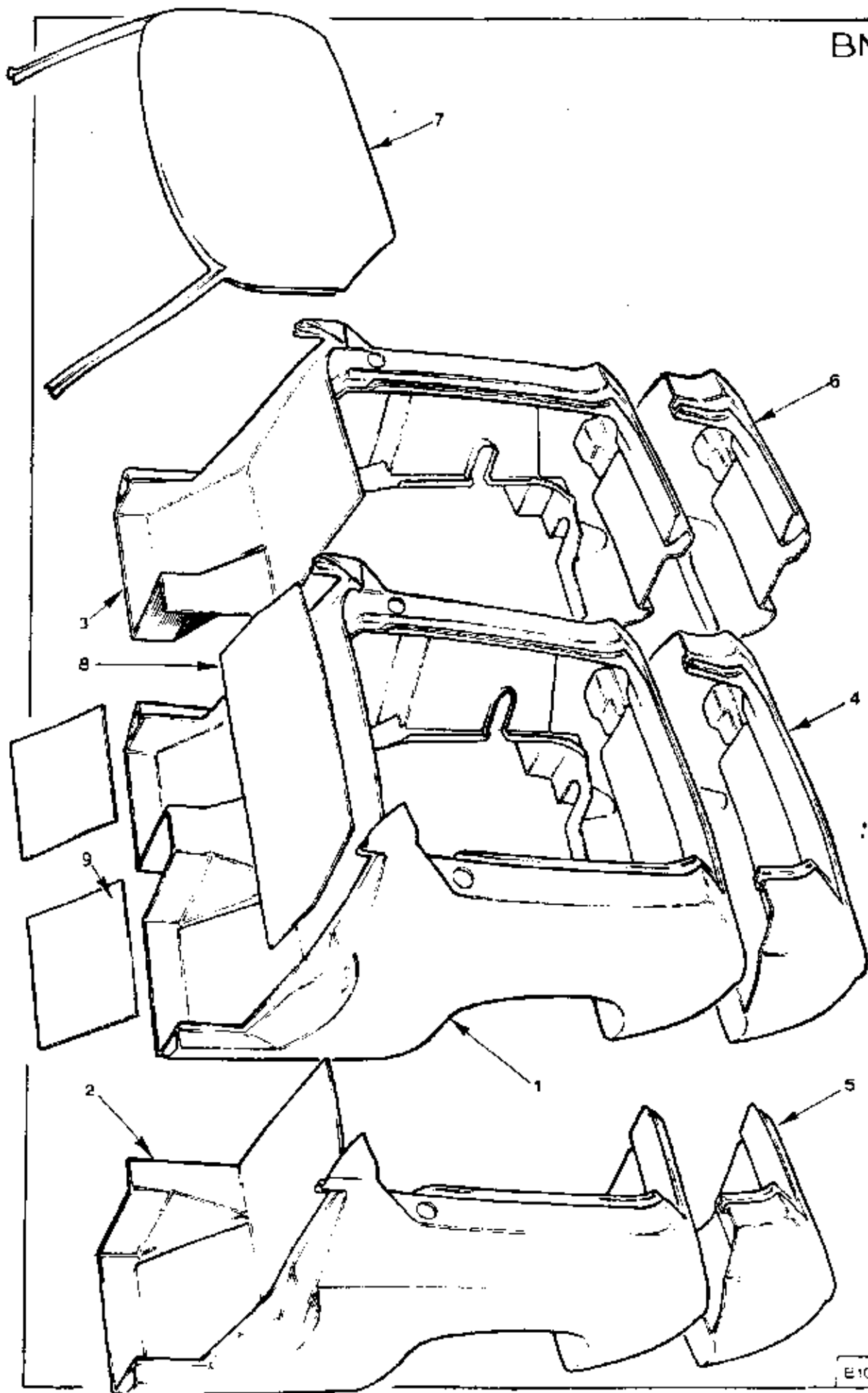

PLATE	PART NO.	QUANTITY					STEERING		DESCRIPTION	CHANGE POINT	BULLETIN RE
		ALL	T/C	T/C Fed.	Special	Spec. Fed.	LH	RH			
Ref: No.											
BL1	A074 B 6018Z	1	1	1			*	*	Body Section. Full Front,		
	B074 B 6018Z				1				Body Section. Full Front,		
BL2	A074 B 6019Z	1	1	1			*	*	Body Section. Half Full Front, - L/H		
	B074 B 6019Z				1				Body Section. Half Full Front, - L/H		
BL3	A074 B 6020Z	1	1	1			*	*	Body Section. Half Full Front, - R/H		
	B074 B 6020Z				1				Body Section. Half Full Front, - R/H		
BL4	A074 B 6021Z	1	1	1			*	*	Body Section. Mid Front,		
	B074 B 6021Z				1				Body Section. Mid Front,		
BL5	A074 B 6022Z	1	1	1			*	*	Body Section. Half Mid Front, - L/H		
	B074 B 6022Z				1				Body Section. Half Mid Front, - L/H		
BL6	A074 B 6023Z	1	1	1			*	*	Body Section. Half Mid Front, - R/H		
	B074 B 6023Z				1				Body Section. Half Mid Front, - R/H		
BL7	A074 B 6011Z	1	1	1			*	*	Body Section. Short Front,		
	B074 B 6011Z				1				Body Section. Short Front,		
BL8	A074 B 6013Z	1	1	1			*	*	Body Section. Half Short Front, - L/H		
	B074 B 6013Z				1				Body Section. Half Short Front, - L/H		
BL9	A074 B 6012Z	1	1	1			*	*	Body Section. Half Short Front, - R/H		
	B074 B 6012Z				1				Body Section. Half Short Front, - R/H		
BL10	A074 B 2104Z	1							Spoiler.		

BM



E105

PLATE	PART NO.	QUANTITY					STEERING		DESCRIPTION	CHANGE POINT	BULLETIN R	
		ALL	T/C	T/C Fed.	Special	Spec. Fed.	LH	RH				
BM1	A074 B 6043Z		1	1	1			*	*	Body Section. Full Rear,		
	B074 B 6043Z									Body Section. Full Rear,		
BM2	A074 B 6045Z		1	1	1			*	*	Body Section. Half Full Rear, - L/H		
	B074 B 6045Z									Body Section. Half Full Rear, - L/H		
BM3	A074 B 6044Z		1	1	1			*	*	Body Section. Half Full Rear, - R/H		
	B074 B 6044Z									Body Section. Half Full Rear, - R/H		
BM4	A074 B 6014Z		1	1	1			*	*	Body Section. Short Rear,		
	B074 B 6014Z									Body Section. Short Rear,		
BM5	A074 B 6015Z		1	1	1			*	*	Body Section. Half Short Rear, - L/H		
	B074 B 6015Z									Body Section. Half Short Rear, - L/H		
BM6	A074 B 6016Z		1	1	1			*	*	Body Section. Half Short Rear, - R/H		
	B074 B 6016Z									Body Section. Half Short Rear, - R/H		
BM7	A074 B 6024Z	1								Panel. Roof, c/w Windscreen Pillars,		
BM8	A074 B 2113Z	1								Board. Bulkhead Upper,		
BM9	B074 B 2097Z	2								Board. Bulkhead Lower,		

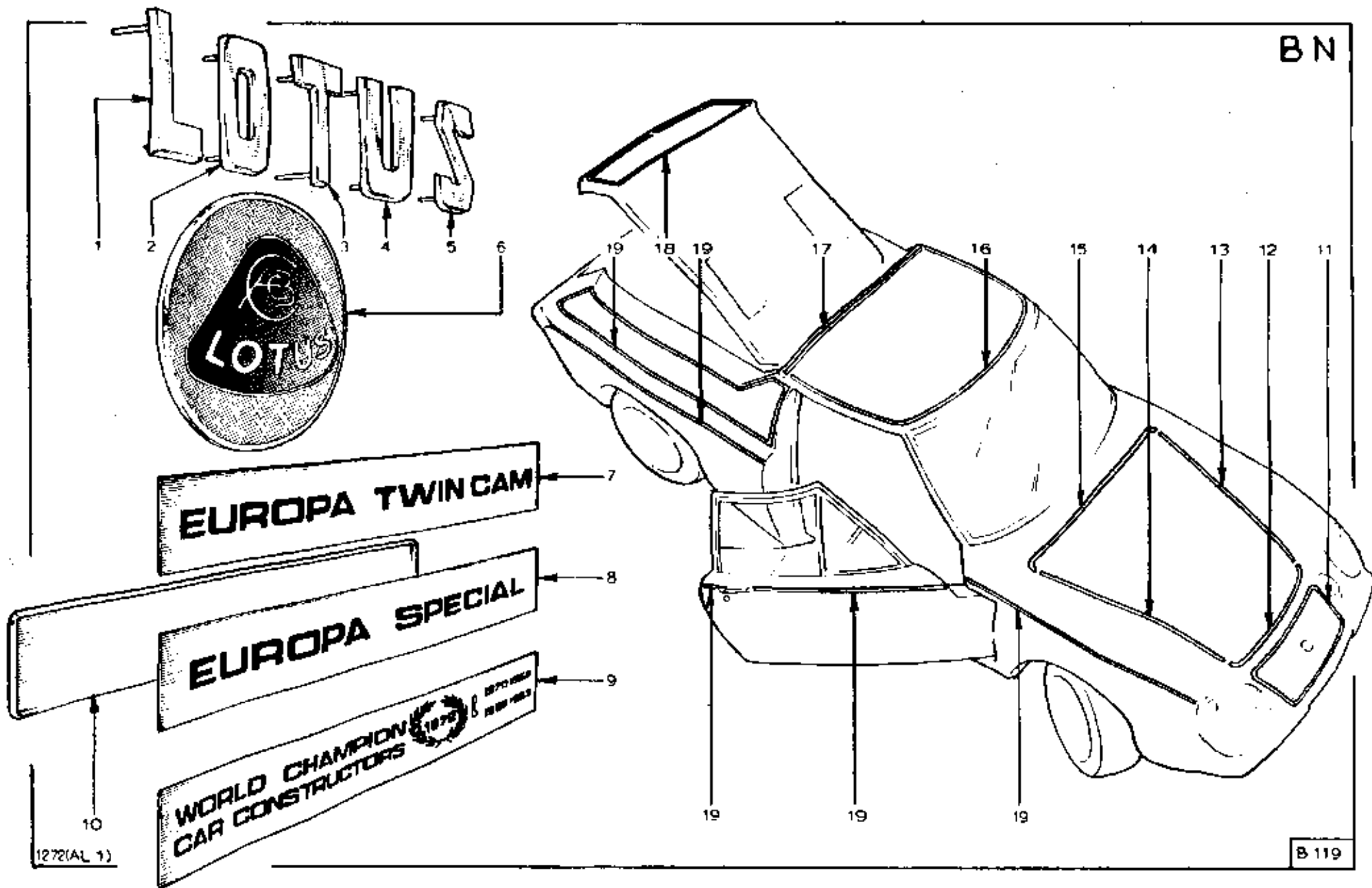

PLATE Ref: No.	PART NO.	QUANTITY					STEERING		DESCRIPTION	CHANGE POINT	BULLETIN
		ALL	T/C	T/C Fed.	Special	Spec. Fed.	LH	RH			
BN18	A074 U 0063Z				1	1	*	*	Decal. Boot Rear,		
BN19	A074 U 0081Z				AR	AR	*	*	Decal.		